

ALL NEW
机电一体新纪元
MECHATRONICS

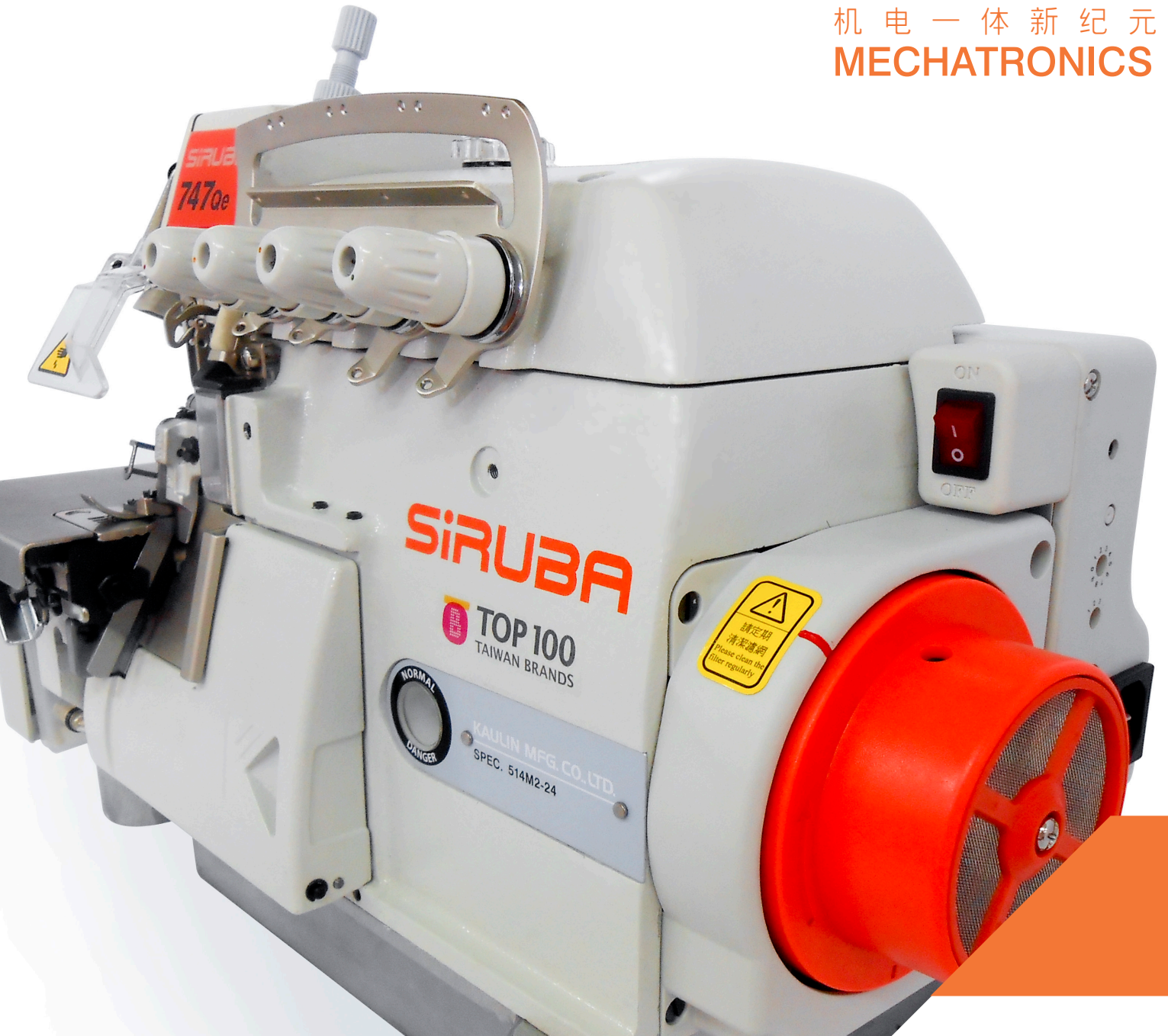

700Qe | Series

机电一体高速型包缝机
Mechatronic High Speed Overlock Stitch Machine

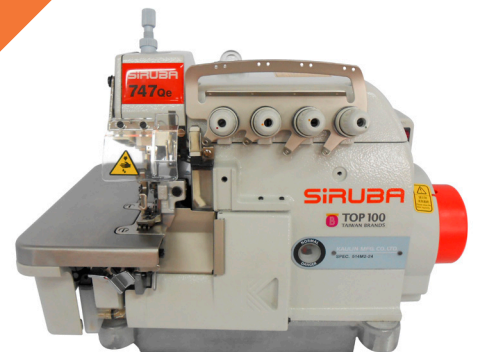

特点 / Feature

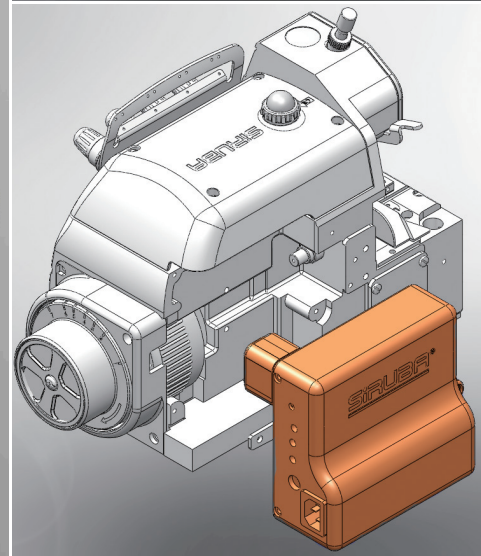
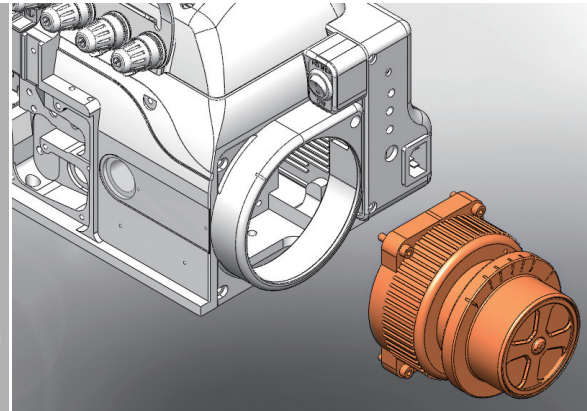

s
p
700Qe
e
d

7500 转!

机 电 一 体 再 提 升

THE UPGRADED MECHATRONICS

Qe 延续 Q 型的精简设计，配备更强大的马达，实现 7500 RPM 的高速车缝。

Qe succeeds the compact design from Q Series. Equipping more powerful motor, 700Qe realizes high speed sewing by 7500 RPM.

广 泛 的 车 缝 应 用

A WIDE RANGE OF SEWING APPLICATIONS

700Qe 与 700K 型的规格组和配件相容，提供完整的包缝工段应用。

The gauge sets and devices of 700Qe are compatible with 700K, which provides a wide range of overlock sewing applications.

MECHATRONIC Overlock Stitch Machine

747

Qe

-

514

M

2

-

2

4 / VT

线数
Thread numbers

机种别
Model

700Qe
机电一体高速型包缝机
Mechatronic High Speed
Overlock Stitch Machine

缝合方式
Sewing types

503

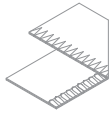

504

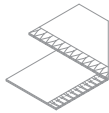

505

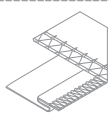

512

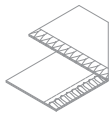

514

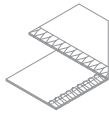

516

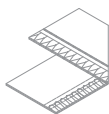

514 + 401

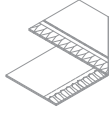

车缝布料
Sewing fabric

F: 轻薄布料
Fine weight fabric

L: 薄布料
Light weight fabric

M: 中厚布料
Medium weight fabric

H: 厚布料
Heavy weight fabric

送具型式
Feed dog type

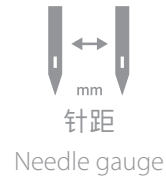

Needle gauge

配件
Device

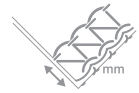











包边宽度
Overedge width

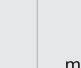

700Qe | Series

Overlock Stitch Machine

| MODEL |  x |  |  mm |  mm |  mm |  |  mm |  mm |  Needle NO. DCX27 |  S.P.M. (Max) |
|-------------------|---|---|---|---|---|--|---|---|---|--|
| 737Qe-504M2-04 | 1 | 3 | - | 4 | - | 0.7-2 | 3.6 | 6.0 | #11 | 7500 |
| 737Qe-504F1-04 | 1 | 3 | - | 4 | - | 0.7-2 | 3.6 | 6.0 | #11 | 7500 |
| 737Qe-504F2-02 | 1 | 3 | - | 2 | - | 0.7-2 | 3.6 | 5.5 | #9 | 7500 |
| 737Qe-504F1-15 | 1 | 3 | - | 1.5 | - | 0.7-2 | 3.6 | 5.5 | #9 | 7500 |
| 737Qe-504M1-15 | 1 | 3 | - | 1.5 | - | 0.7-2 | 3.6 | 6.0 | #9 | 7500 |
| 737Qe-505F1-04 | 1 | 3 | - | 4 | - | 0.7-2 | 3.6 | 6.0 | #9 | 7500 |
| 737Qe-504M2-04/TR | 1 | 3 | - | 4 | - | 0.7-2 | 3.6 | 6.0 | #11 | 7500 |
| 737Qe-504M3-04 | 1 | 3 | - | 4 | - | 0.7-2 | 3.6 | 6.0 | #11 | 7500 |
| 737Qe-504M3-05/PZ | 1 | 3 | - | 5 | - | 0.7-2 | 3.6 | 6.0 | #18 | 7500 |
| 737Qe-504M5-04/BK | 1 | 3 | - | 4 | - | 0.7-2 | 3.6 | 6.0 | #11 | 7500 |
| 747Qe-514M2-24 | 2 | 4 | 2 | 4 | 6 | 0.7-2 | 3.6 | 5.5 | #11 | 7500 |
| 747Qe-512M1-25 | 2 | 4 | 2 | 5 | 7 | 0.7-2 | 3.6 | 5.5 | #11 | 7500 |
| 747Qe-514F1-24 | 2 | 4 | 2 | 4 | 6 | 0.7-2 | 3.6 | 5.5 | #11 | 7500 |
| 747Qe-514M2-24/TG | 2 | 4 | 2 | 4 | 6 | 0.7-2 | 3.6 | 6.0 | #11 | 7500 |
| 747Qe-514M2-28 | 2 | 4 | 2 | 8 | 10 | 0.7-2 | 3.6 | 4.0 | #11 | 7500 |
| 747Qe-514H4-24/GA | 2 | 4 | 2 | 4 | 6 | 0.7-2 | 3.2 | 5.5 | #11 | 7500 |
| 747Qe-514M4-23 | 2 | 4 | 2 | 3 | 5 | 0.7-2 | 3.6 | 6.0 | #11 | 7500 |
| 747Qe-514M5-23/BK | 2 | 4 | 2 | 3 | 5 | 0.7-2 | 3.6 | 6.0 | #11 | 7500 |
| 747Qe-514M7-24 | 2 | 4 | 2 | 4 | 6 | 0.7-2 | 3.6 | 7.0 | #16 | 7500 |
| 747Qe-514M7-24/BK | 2 | 4 | 2 | 4 | 6 | 0.7-2 | 3.6 | 7.0 | #16 | 7500 |
| 747Qe-514M7-24/TG | 2 | 4 | 2 | 4 | 6 | 0.7-2 | 3.6 | 7.0 | #16 | 7500 |
| 757Qe-516M2-35 | 2 | 5 | 3 | 5 | 8 | 0.7-2 | 3.6 | 6.0 | #14 | 7500 |
| 757Qe-516L1-24 | 2 | 5 | 2 | 4 | 6 | 0.7-2 | 3.6 | 6.0 | #11 | 7500 |
| 757Qe-401M1/TW | 1 | 2 | - | - | - | 0.7-2 | 3.6 | 5.5 | #14 | 7500 |
| 757Qe-516H4-35/GA | 2 | 5 | 3 | 5 | 8 | 0.7-2 | 3.6 | 6.0 | #14 | 7500 |
| 757Qe-516M2-35/PS | 2 | 5 | 3 | 5 | 8 | 0.7-2 | 3.6 | 6.0 | #14 | 7500 |
| 757Qe-401M2-50/TA | 2 | 4 | 5 | - | - | 0.7-2 | 3.6 | 6.0 | #14 | 7500 |
| 767Qe-516M2-324 | 3 | 6 | 3+2 | 4 | 9 | 0.7-2 | 3.6 | 6.0 | #11 | 7500 |

 高林股份有限公司
KAULIN MFG. CO., LTD.

由於對產品的改良及更新，本產品型錄中之產品規格及外觀的修改恕不事先通知！
The specification and/or appearances of the equipment described in this catalogue are subject to change without previous notice because of modification.

 TOP 100
TAIWAN BRANDS



ISO 9001:2000
ISO 14001:2004

